

**NJUG NOTE**  
ALL WORKS TO BE CARRIED OUT IN LINE WITH THE CURRENT NATIONAL JOINT UTILITIES GROUP GUIDELINES

**SAFETY, HEALTH AND ENVIRONMENTAL INFORMATION BOX**  
NOTES: THIS DRAWING IS TO BE READ IN CONJUNCTION WITH THE RISK REGISTER PRODUCED FOR INCLUSION IN THE HEALTH AND SAFETY PLAN. THE HAZARDS NOTED ARE IN ADDITION TO THE NORMAL HAZARDS AND RISKS FACED BY A COMPETENT CONTRACTOR WHEN DEALING WITH THE TYPE OF WORKS DETAILED ON THIS DRAWING.

**CONSTRUCTION RISKS:**  
**MAINTENANCE/CLEANING RISKS:**  
**DEMOLITION RISKS:**

**GENERAL NOTES**

- 1) THIS DOCUMENT HAS BEEN PREPARED IN ACCORDANCE WITH THE SCOPE OF ROSSI LONG CONSULTING'S APPOINTMENT WITH ITS CLIENT AND IS SUBJECT TO THE TERMS OF THAT APPOINTMENT. ROSSI LONG CONSULTING ACCEPTS NO LIABILITY FOR ANY USE OF THIS DOCUMENT OTHER THAN BY ITS CLIENT AND ONLY FOR THE PURPOSES FOR WHICH IT WAS PREPARED AND PROVIDED. ONLY WRITTEN DIMENSIONS SHALL BE USED.
- 2) THIS DRAWING IS TO BE READ IN CONJUNCTION WITH ALL RELEVANT ENGINEER'S DRAWINGS AND DETAILS, THE SPECIFICATION FOR THE WORKS, THE RELEVANT ARCHITECT'S DRAWINGS AND ANY OTHER SPECIALIST'S DRAWINGS.
- 3) THIS DRAWING IS BASED ON TOPOGRAPHICAL SURVEY CARRIED OUT BY TOWER SURVEYS AS DEPICTED ON THEIR DRAWINGS R-44185 201 TO 205.
- 4) ALL LEVELS ARE IN METRES AND RELATED TO ORDNANCE DATUM.
- 5) EXISTING SERVICES ARE NOT NECESSARILY ALL SHOWN ON THIS OR OTHER DRAWINGS. THE POSITION OF EXISTING SERVICES SHALL BE LOCATED AND MARKED OUT ON THE GROUND BY THE CONTRACTOR WITH THE SERVICE PROVIDER PRIOR TO THE COMMENCEMENT OF ANY GROUND WORKS.
- 6) THE PURPOSE OF THIS DRAWING IS TO SHOW DETAILS FOR THE CONSTRUCTION OF THE PROPOSED SECTION 278 WORKS. THESE INCLUDE FOUR PASSING BAYS, CHANGES TO EXISTING KERB LINE AND THE BELLMOUTH OF THE PROPOSED ESTATE ROAD.
- 7) ALL WORKS WITHIN THE EXISTING HIGHWAY SHALL BE CARRIED OUT BY A CONTRACTOR WHO HAS BEEN APPROVED BY NORFOLK COUNTY COUNCIL TO CARRY OUT WORK WITHIN A PUBLIC HIGHWAY. THE WORK SHALL BE CARRIED OUT FULLY IN ACCORDANCE WITH THE 'NEW ROADS AND STREET WORKS ACT 1991' AND TO CHAPTER 8 OF THE 'TRAFFIC SIGNS MANUAL'. THE CONTRACTOR SHALL PROVIDE, ERECT, MAINTAIN AND REMOVE UPON COMPLETION ALL TEMPORARY SIGNING REQUIRED FOR WORKS CARRIED OUT WITHIN THE EXISTING HIGHWAY. HE SHALL LIAISE WITH THE STREET WORKS COORDINATOR OF THE COUNTY COUNCIL WITH REGARD TO PLANNING AND AGREEING APPROPRIATE METHODS OF TRAFFIC MANAGEMENT. ALL REQUIRED NOTICES SHALL BE PLACED WITH THE COUNTY COUNCIL BY THE CONTRACTOR PRIOR TO WORKS COMMENCING IN THE HIGHWAY.
- 8) ALL REINSTATEMENT TO THE EXISTING HIGHWAY SHALL BE CARRIED OUT FULLY IN ACCORDANCE WITH THE HAUC 'SPECIFICATION FOR THE REINSTATEMENT OF OPENINGS IN HIGHWAYS'. REINSTATEMENT SHALL BE PERMANENT (ON FIRST VISIT) AND TO THE APPROVAL OF NORFOLK COUNTY COUNCIL. TRENCH BACKFILL MATERIAL SHALL BE TYPE 1 GRANULAR SUB-BASE.
- 9) THE CONTRACTOR SHALL SUBMIT TO THE STREET WORKS COORDINATOR AND UTILITY COMPANIES THE APPROPRIATE 'N' NOTICES. UPON COMPLETION OF THE WORKS THE CONTRACTOR SHALL SUBMIT TO THE STREET WORKS COORDINATOR THE APPROPRIATE 'R' NOTICE.
- 10) ALL PROPRIETARY MATERIALS SHALL BE INSTALLED IN ACCORDANCE WITH THE MANUFACTURER'S INSTRUCTIONS AND RECOMMENDATIONS.
- 11) THE MAIN CONTRACTOR IS RESPONSIBLE FOR ACHIEVING AND MAINTAINING THE STABILITY OF EARTHWORKS AND ANY EXISTING STRUCTURES ON THE SITE AND ADJOINING SITES, TAKING ALL NECESSARY PRECAUTIONS TO SAFEGUARD THIS STABILITY. ADEQUATE SHORING IS TO BE INSERTED DURING THE WORKS TO ENSURE STABILITY AND SUCH SHORING IS TO BE ADEQUATELY FOUNDED AND BRACED.
- 12) DRAINAGE SOAKAWAYS FOR PASSING BAYS HAVE BEEN SIZED FOR A DRAINED AREA EQUAL TO THE AREA OF THE PASSING BAY PLUS HALF OF THE ADJACENT EXISTING CARRIAGEWAY. THE SOAKAWAYS ARE DESIGNED FOR A 10 YEAR STORM AND AN ASSUMED DESIGN INFILTRATION RATE OF 5x10<sup>-3</sup> m/s. SEE DRAWING 141222/CL-1012 FOR SOAKAWAY DETAILS.

© ROSSI LONG CONSULTING 2018.

REV	DESCRIPTION	DATE	BY	AUTH
P1	FIRST ISSUE FOR APPROVAL/COMMENT	12/03/18	PW	GMA

**Rossi Long Consulting**  
16 Meridian Way, Norwich, Norfolk, NR7 0TA  
T: 01603 706 420 F: 01603 706 421 www.rossilong.co.uk

CLIENT  
**IAN ALSTON HONINGHAM THORPE FARMS**

PROJECT  
**NORFOLK FOOD HUB CHURCH LANE, EASTON**

TITLE  
**GENERAL ARRANGEMENT OF PROPOSED S278 WORKS ON CHURCH LANE**

DRAWN	AUTHORISED	DATE	SCALE AT A1
PW	GMA	12/03/18	1:2500; 1:200
PROJECT NO.	DRAWING NO.	REV	
141222	CL-1010	P1	

STAGE: **PRELIMINARY**

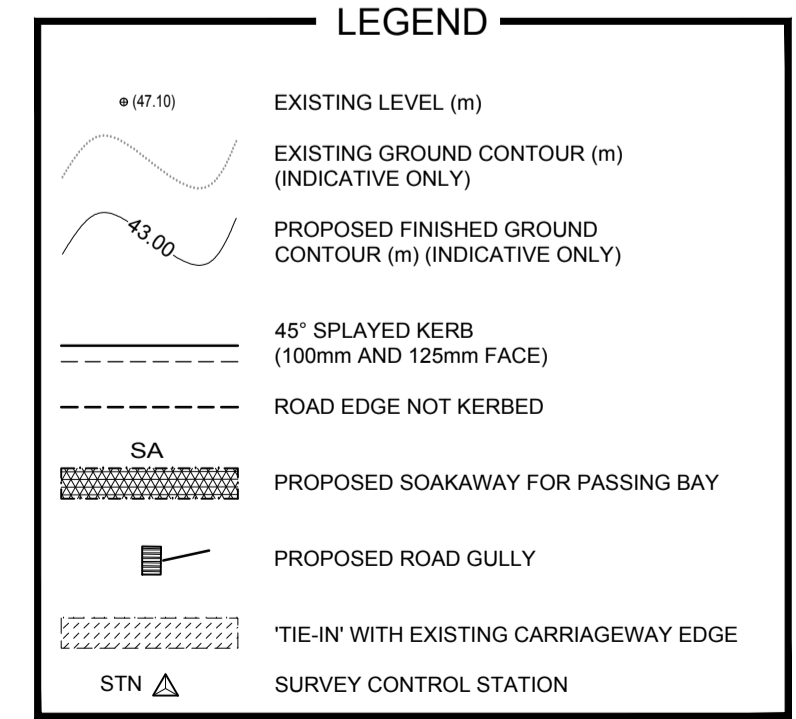
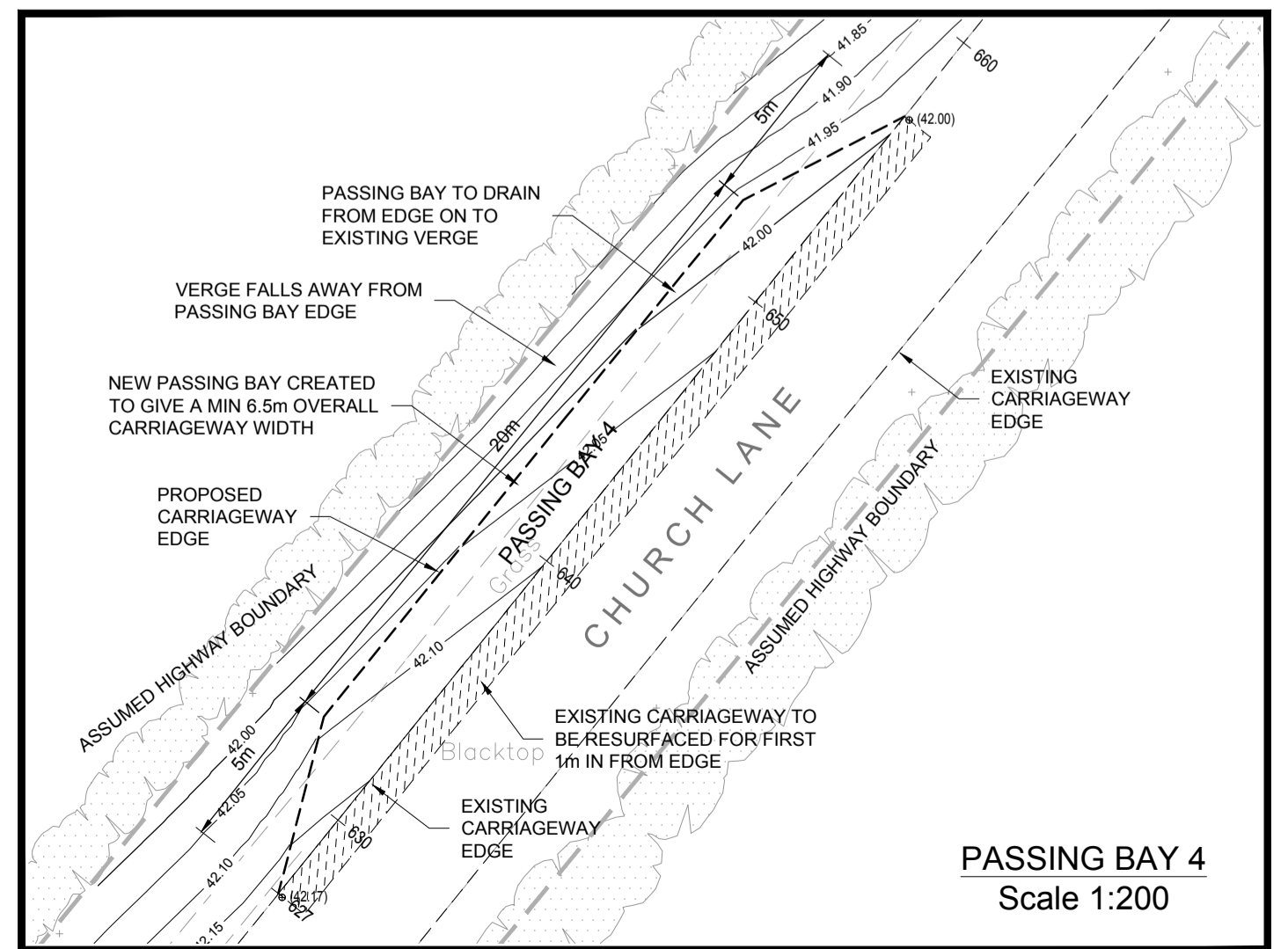
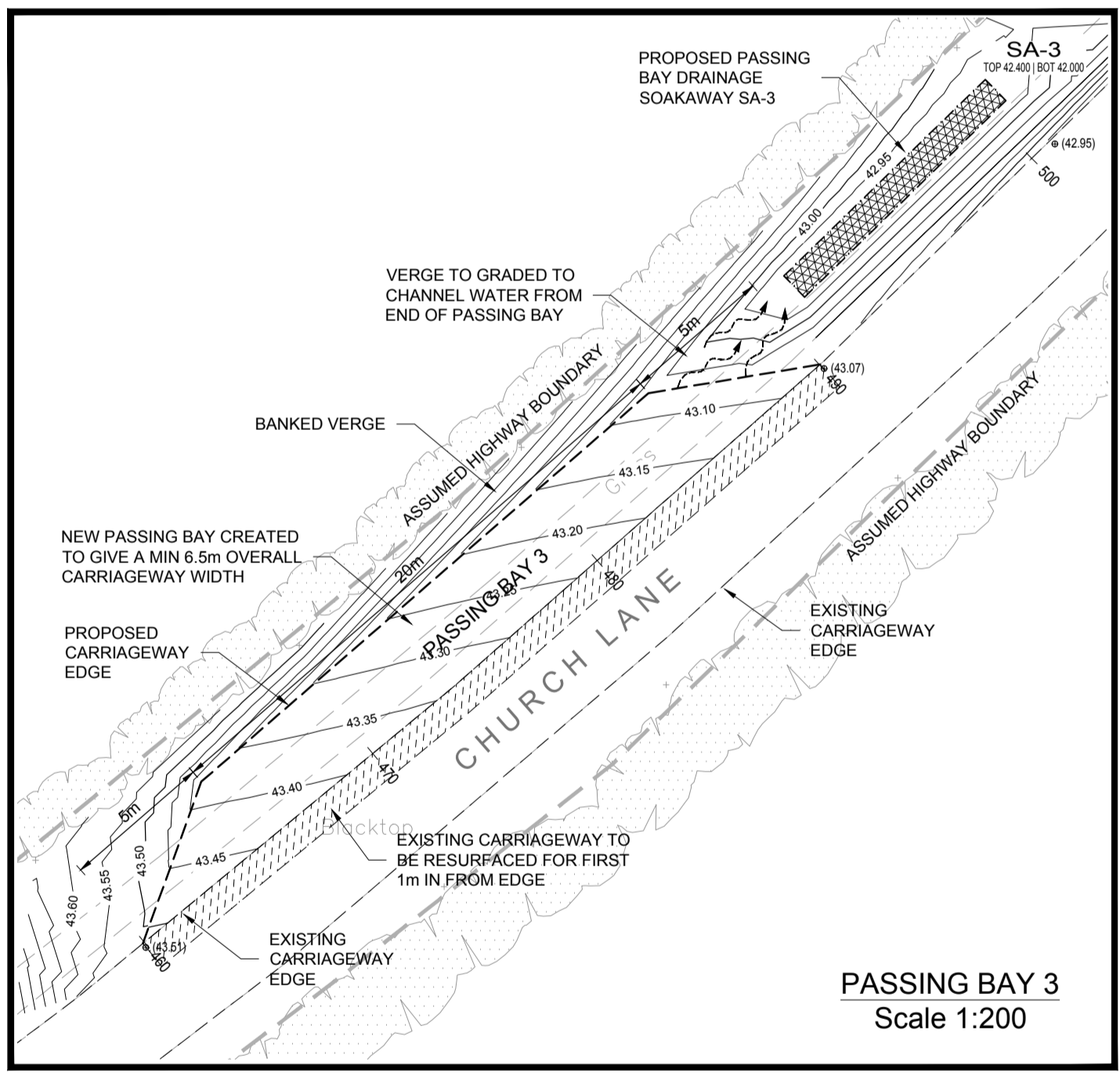
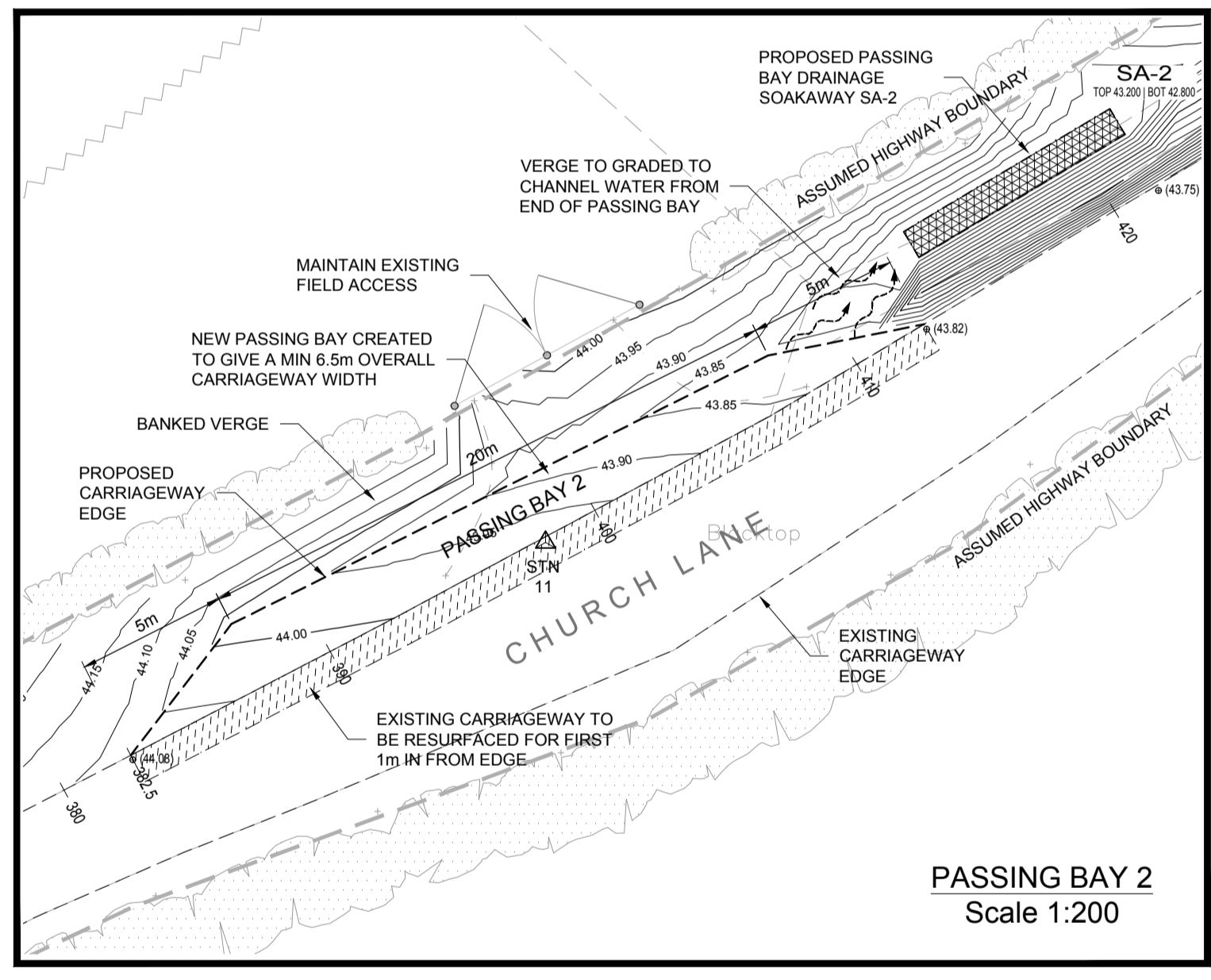
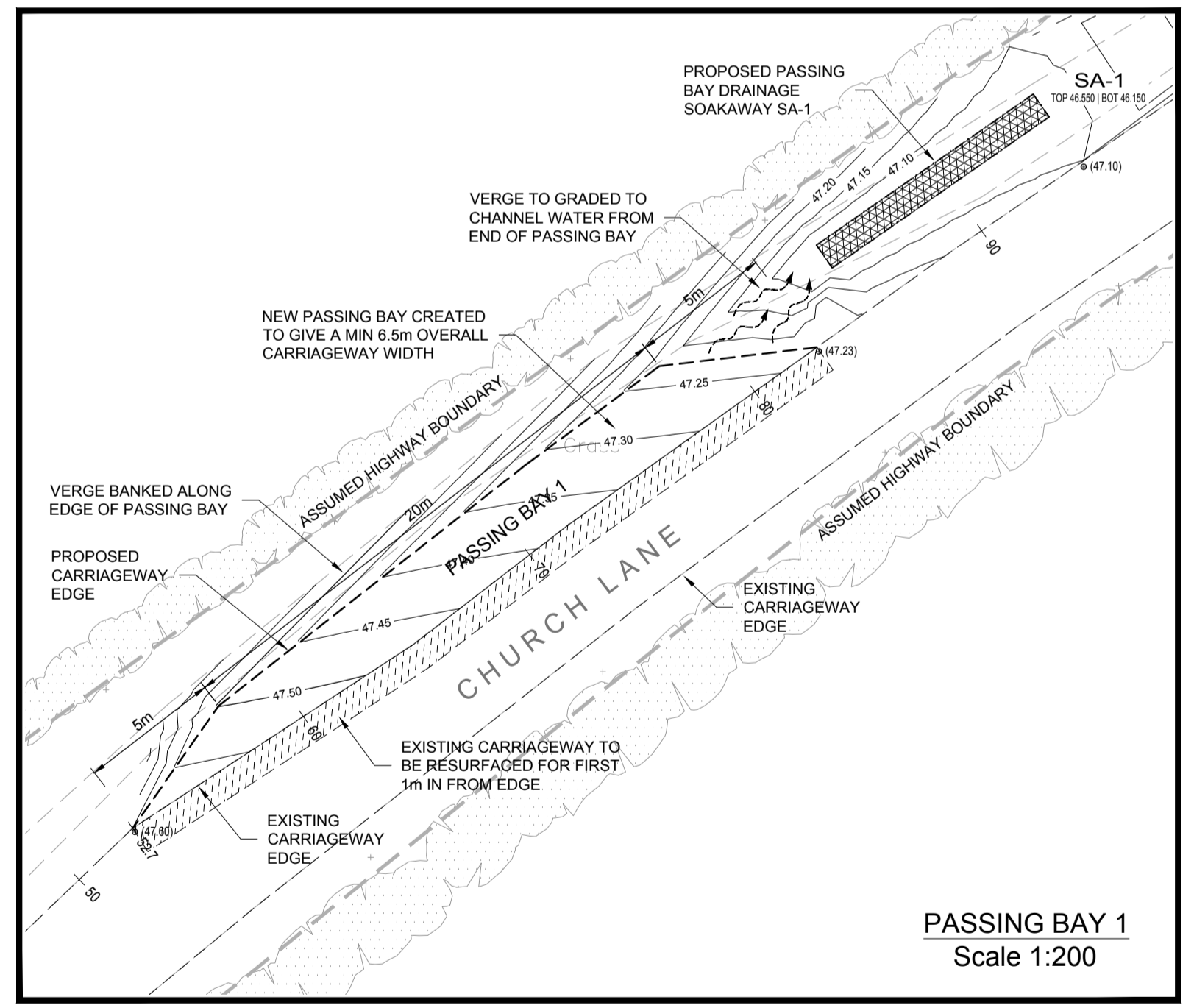
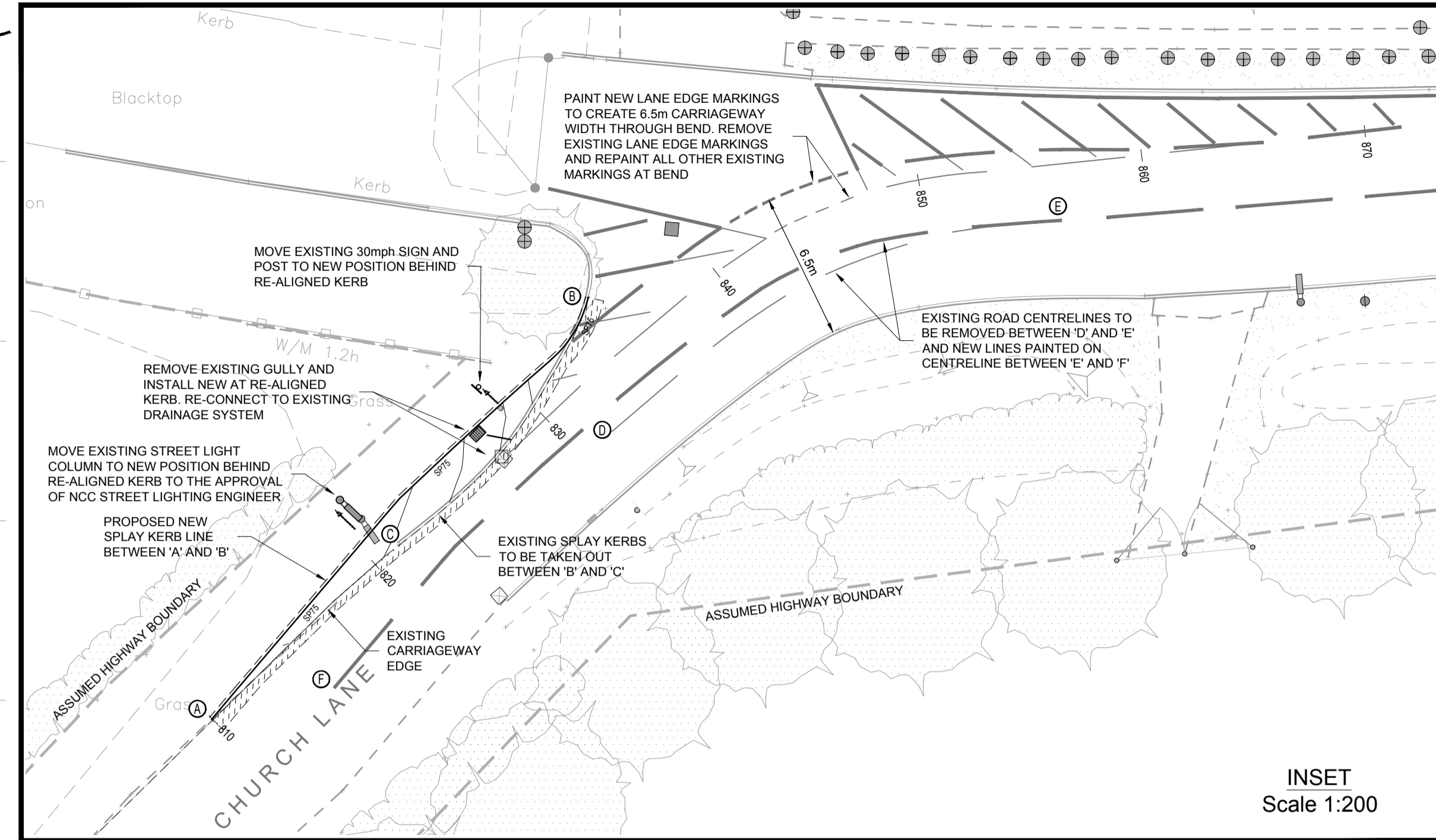
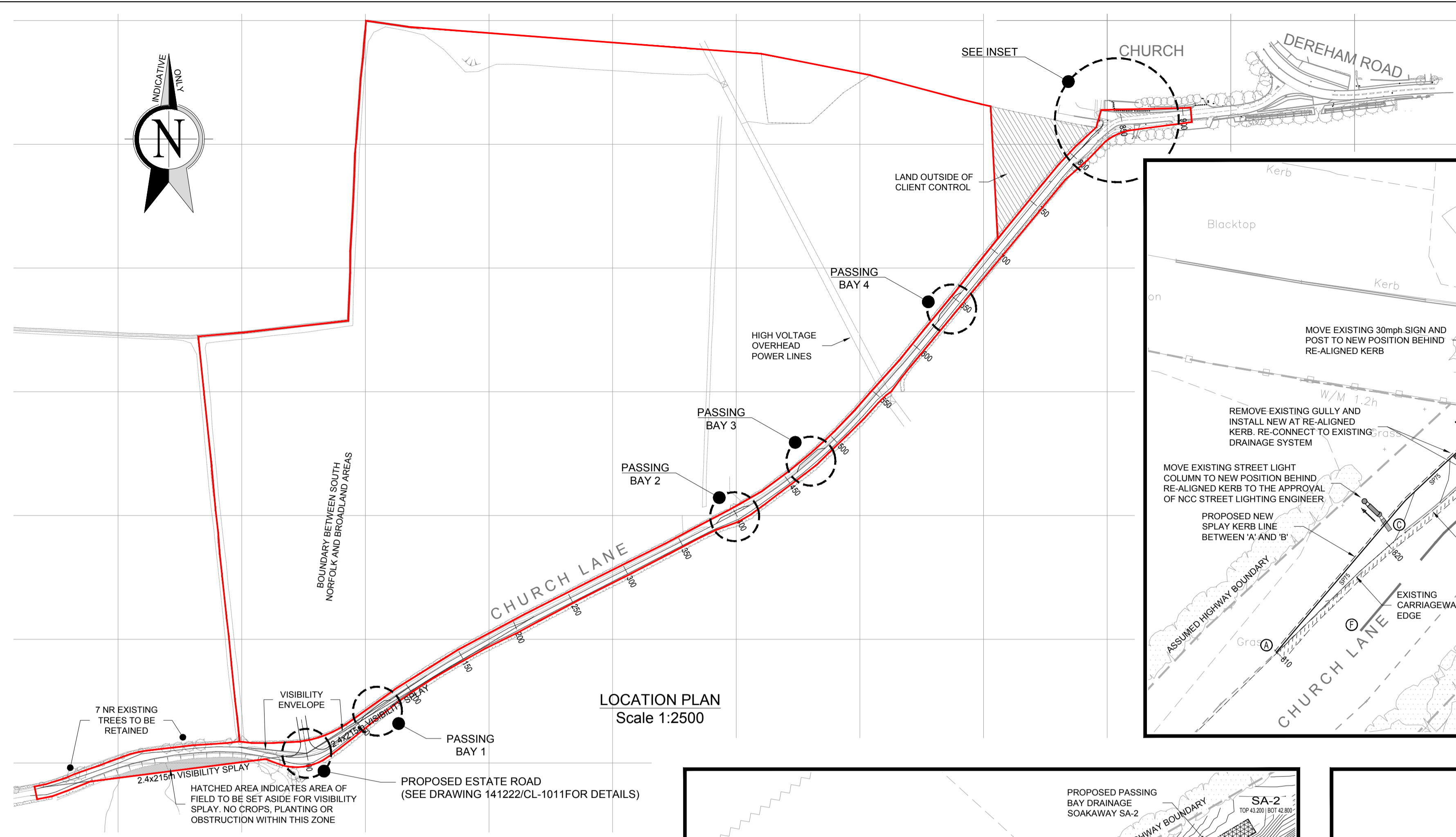

**PRELIMINARY DRAWING:**  
THIS DRAWING IS FOR PRELIMINARY PURPOSES ONLY AND MUST NOT BE READ AS A CONSTRUCTION ISSUE. IT INDICATES DESIGN INTENT ONLY AND IS SUBJECT TO AMENDMENT DURING FINAL DESIGN DEVELOPMENT.